

Qty.	Description
1	<p>CM 1-3 A-R-I-E-AQQE F-A-A-N</p>  <p>Note! Product picture may differ from actual product</p> <p>Product No.: On request</p> <p>Compact, reliable, horizontal, multistage, end-suction centrifugal pump with axial suction port and radial discharge port. Pump materials in contact with the liquid are in stainless steel. The mechanical shaft seal is a special designed, unbalanced O-ring seal. Pipework connection is via internal Whitworth pipe threads, Rp (ISO 7/1).</p> <p>The pump is fitted with a 3-phase, foot-mounted, fan-cooled asynchronous motor.</p> <p>Controls:</p> <p>Frequency converter: NONE</p> <p>Liquid:</p> <p>Pumped liquid: Water</p> <p>Liquid temperature range: -20 .. 120 °C</p> <p>Selected liquid temperature: 20 °C</p> <p>Density: 998.2 kg/m³</p> <p>Technical:</p> <p>Pump speed on which pump data are based: 2900 rpm</p> <p>Rated flow: 1.7 m³/h</p> <p>Rated head: 18.82 m</p> <p>Code for shaft seal: AQQE</p> <p>Approvals: CE,EAC</p> <p>Approvals for drinking water: WRAS,ACS,NSF61,UBA</p> <p>Curve tolerance: ISO9906:2012 3B</p> <p>Materials:</p> <p>Pump housing: Stainless steel EN 1.4301 AISI 304</p> <p>Impeller: Stainless steel EN 1.4301 AISI 304</p> <p>Installation:</p> <p>Range of ambient temperature: -20 .. 55 °C</p> <p>Maximum operating pressure: 16 bar</p> <p>Max pressure at stated temp: 16 bar / 90 °C 10 bar / 120 °C</p> <p>Type of connection: Rp</p> <p>Size of inlet connection: 1 inch</p> <p>Size of outlet connection: 1 inch</p> <p>Outlet position: 12</p> <p>Electrical data:</p> <p>Motor standard: IEC</p> <p>Frame size: 71A</p> <p>Rated power - P2: 0.46 kW</p> <p>Mains frequency: 50 Hz</p> <p>Suitable for 50/60 Hz: N</p> <p>Rated voltage: 3 x 220-240D/380-415Y V</p> <p>Service factor: 1.00</p> <p>Rated current: 2,0-2,2/1,0-1,2 A</p>

Qty.	Description
1	<div> <div>Starting current:</div> <div>490-530 %</div> </div> <div> <div>Rated speed:</div> <div>2770-2820 rpm</div> </div> <div> <div>Enclosure class (IEC 34-5):</div> <div>IP55</div> </div> <div> <div>Insulation class (IEC 85):</div> <div>F</div> </div> <div> <div>Built-in motor protection:</div> <div>NONE</div> </div> <div> <div>Cable included (Yes/No):</div> <div>N</div> </div> <div>Others:</div> <div> <div>Terminal box position:</div> <div>12</div> </div> <div> <div>Minimum efficiency index, MEI ≥:</div> <div>0.68</div> </div> <div> <div>Net weight:</div> <div>11.7 kg</div> </div> <div> <div>Gross weight:</div> <div>14.2 kg</div> </div> <div> <div>Danish VVS No.:</div> <div>385214103</div> </div> <div> <div>Country of origin:</div> <div>HU</div> </div> <div> <div>Custom tariff no.:</div> <div>84137075</div> </div>

On request CM 1-3 A-R-I-E-AQQE F-A-A-N 50 Hz

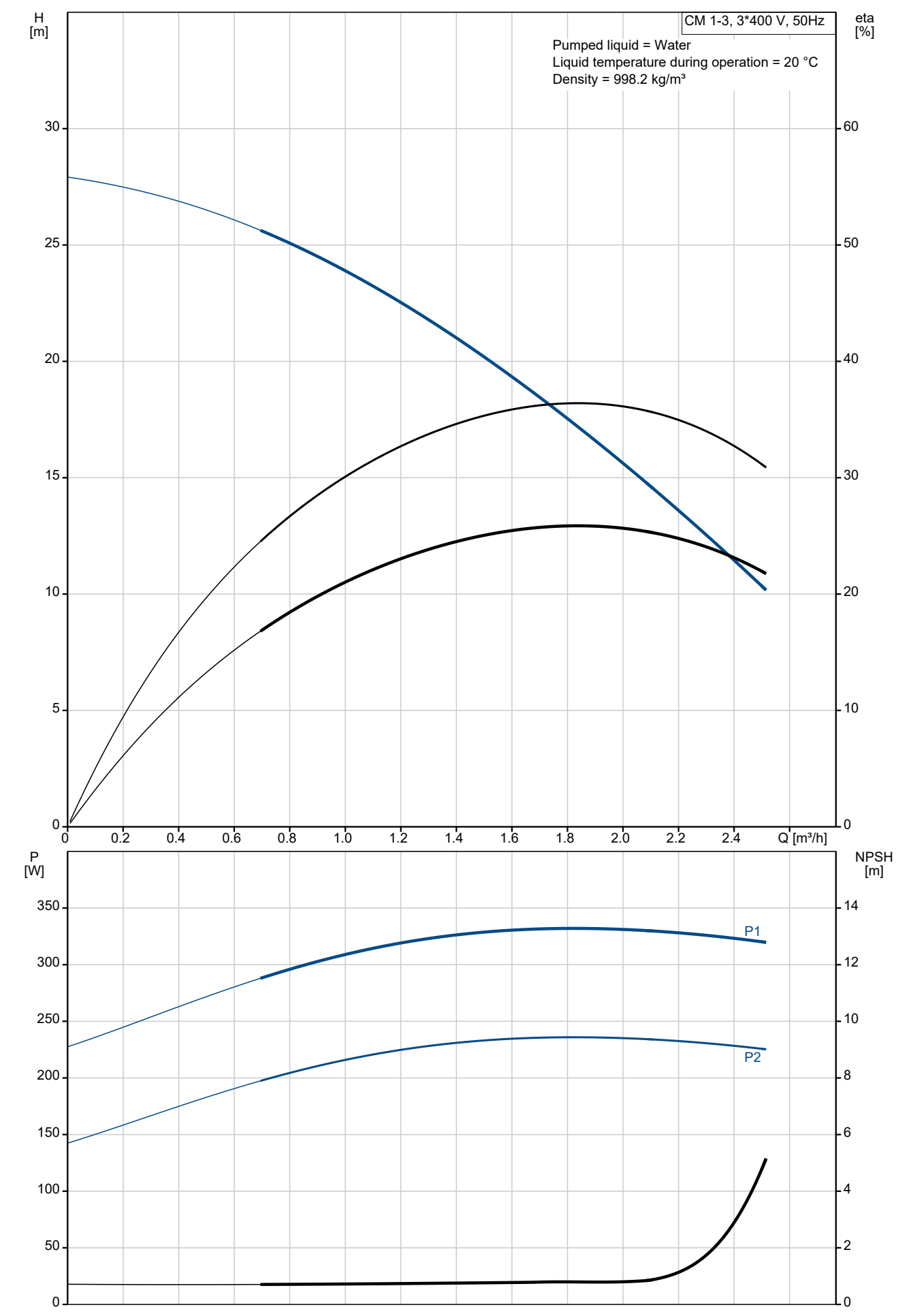

Description	Value		
General information:			
Product name:	CM 1-3 A-R-I-E-AQQE F-A-A-N		
Product No:	On request		
EAN number:	On request		
Technical:			
Pump speed on which pump data are based:	2900 rpm		
Rated flow:	1.7 m³/h		
Rated head:	18.82 m		
Impellers:	3		
Code for shaft seal:	AQQE		
Approvals:	CE,EAC		
Approvals for drinking water:	WRAS,ACS,NSF61,UBA		
Curve tolerance:	ISO9906:2012 3B		
Pump version:	A		
Model:	A		
Materials:			
Pump housing:	Stainless steel		
Pump housing:	EN 1.4301		
Pump housing:	AISI 304		
Impeller:	Stainless steel		
Impeller:	EN 1.4301		
Impeller:	AISI 304		
Material code:	I		
Code for rubber:	E		
Installation:			
Range of ambient temperature:	-20 .. 55 °C		
Maximum operating pressure:	16 bar		
Max pressure at stated temp:	16 bar / 90 °C		
Max pressure at stated temp:	10 bar / 120 °C		
Type of connection:	Rp		
Size of inlet connection:	1 inch		
Size of outlet connection:	1 inch		
Outlet position:	12		
Connect code:	R		
Liquid:			
Pumped liquid:	Water		
Liquid temperature range:	-20 .. 120 °C		
Selected liquid temperature:	20 °C		
Density:	998.2 kg/m³		
Electrical data:			
Motor standard:	IEC		
Frame size:	71A		
Rated power - P2:	0.46 kW		
Mains frequency:	50 Hz		
Suitable for 50/60 Hz:	N		
Rated voltage:	3 x 220-240D/380-415Y V		
Service factor:	1.00		
Rated current:	2,0-2,2/1,0-1,2 A		
Starting current:	490-530 %		
Rated speed:	2770-2820 rpm		
Enclosure class (IEC 34-5):	IP55		
Insulation class (IEC 85):	F		
Built-in motor protection:	NONE		
Cable included (Yes/No):	N		
Controls:			
Frequency converter:	NONE		
Others:			
Terminal box position:	12		
Minimum efficiency index, MEI ≥:	0.68		
Net weight:	11.7 kg		
Gross weight:	14.2 kg		
Danish VVS No.:	385214103		

CM 1-3, 3*400 V, 50Hz

Pumped liquid = Water
Liquid temperature during operation = 20 °C
Density = 998.2 kg/m³

H [m]

eta [%]

Q [m³/h]

NPSH [m]

P [W]

P1

P2

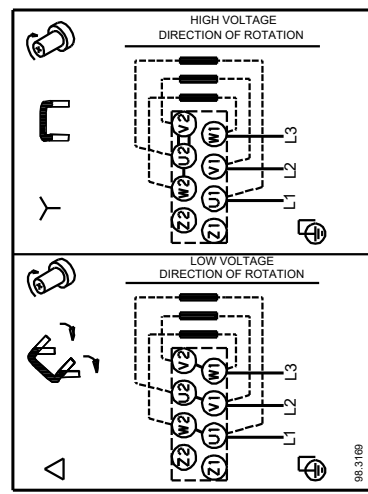
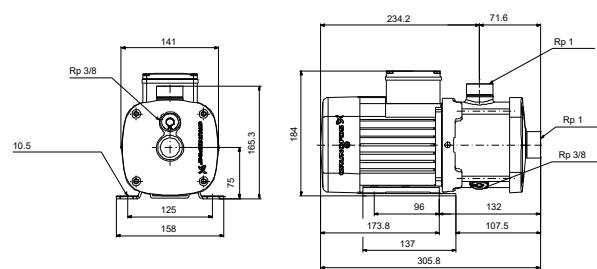
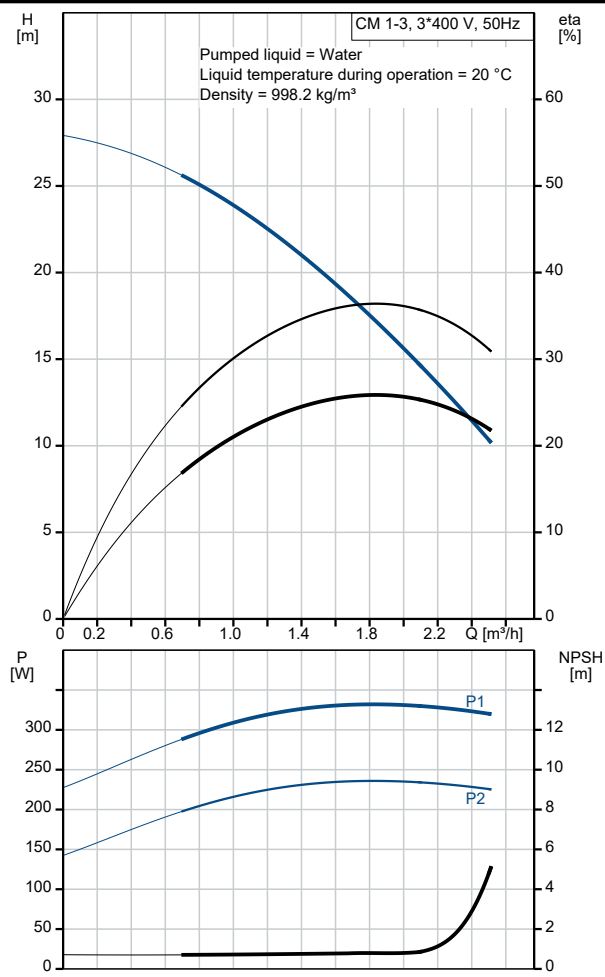

Description	Value
Country of origin:	HU
Custom tariff no.:	84137075

On request CM 1-3 A-R-I-E-AQQE F-A-A-N 50 Hz

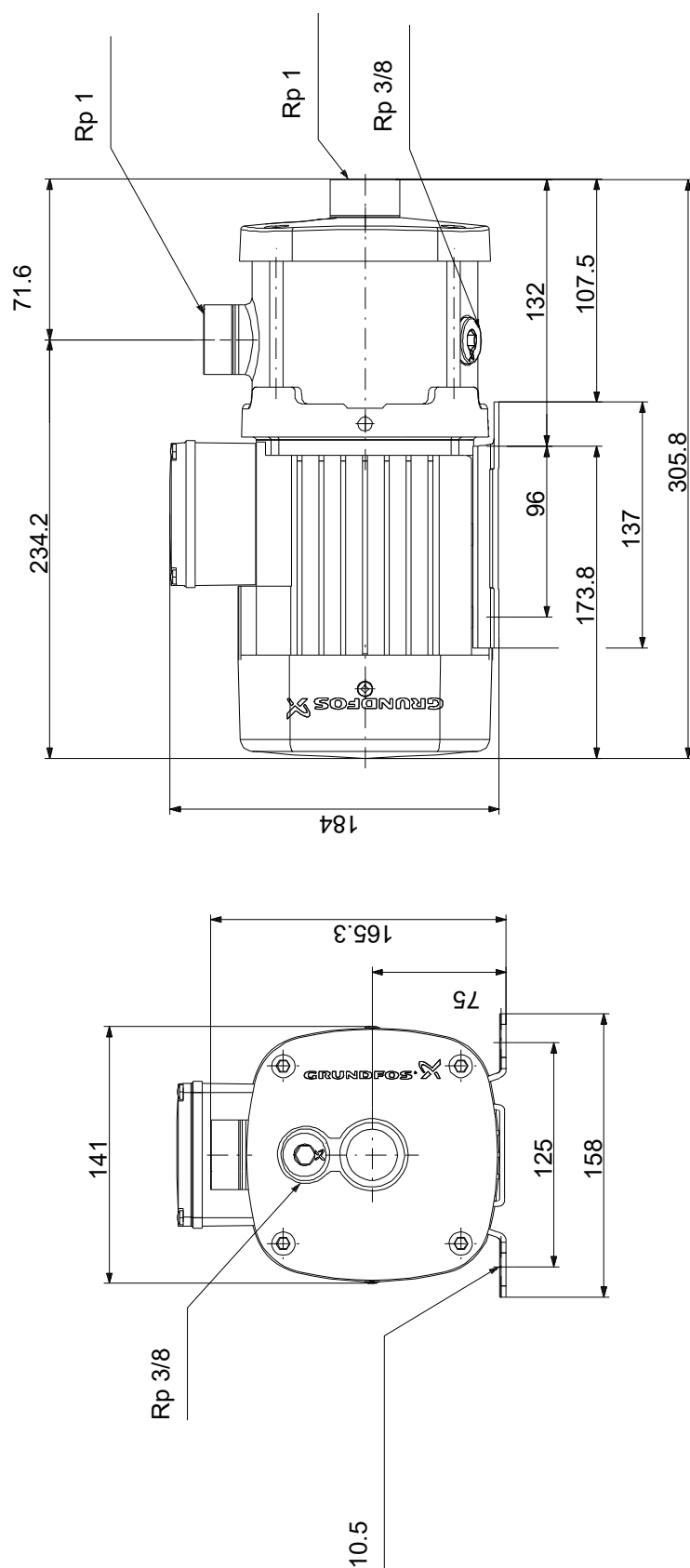

Note! All units are in [mm] unless others are stated.
Disclaimer: This simplified dimensional drawing does not show all details.

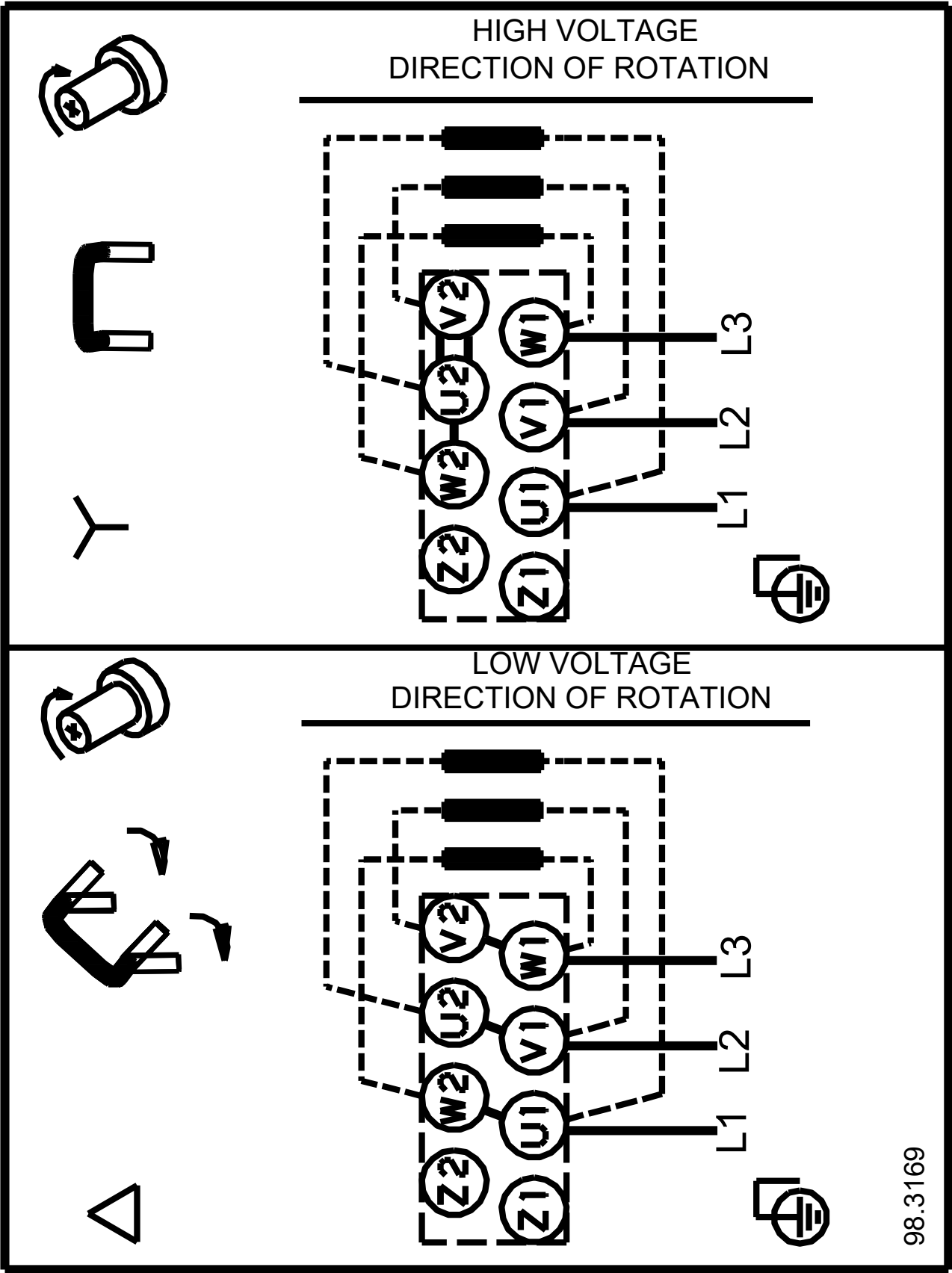

98.3169

Note! All units are in [mm] unless others are stated.

Order Data:	
--------------------	--

Position	Your pos.	Product name	Amount	Product No	Total
		CM 1-3	1	On request	Price on request