

Qty.	Description
------	-------------

1	UPS 15-50 N 130
---	-----------------



Note! Product picture may differ from actual product

Product No.: On request

The pump is of the canned rotor type, i.e. pump and motor form an integral unit without shaft seal and with only two gaskets for sealing. The bearings are lubricated by the pumped liquid. The pump has 3-step speed selector.

The pump is characterized by:

- * Ceramic shaft and radial bearings.
- * Carbon axial bearing.
- * Stainless steel rotor can and bearing plate.
- * Corrosion-resistant impeller, Composite, PES/PP.
- * Stainless steel pump housing.

The motor is a 1-phase motor.

No additional motor protection is required.

Liquid:

Pumped liquid: Water
 Liquid temperature range: 2 .. 110 °C
 Selected liquid temperature: 60 °C
 Density: 983.2 kg/m³

Technical:

TF class: 110
 Approvals on nameplate: CE, WEEE, UKCA

Materials:

Pump housing: Stainless steel
 DIN W.-Nr. 1.4301
 Impeller: Composite, PES/PP

Installation:

Amb. max at 80 dgr C liquid: 40 °C
 Maximum operating pressure: 10 bar
 Pipe connection: G 1 1/2
 Pressure rating: PN 10
 Port-to-port length: 130 mm

Electrical data:

Power input in speed 1: 35 W
 Power input in speed 2: 45 W
 Max. power input: 50 W
 Mains frequency: 50 Hz
 Rated voltage: 1 x 230 V
 Current in speed 1: 0.16 A
 Current in speed 2: 0.2 A
 Current in speed 3: 0.23 A



Company name: Pump Sales Direct

Created by:

Phone: 08000086405

Email: customerservices@pumpsalesdirect.co.uk

Date: 01/08/2022

Qty.	Description
1	<div>Capacitor size - run: 2 μF</div> <div>Enclosure class (IEC 34-5): IP44</div> <div>Insulation class (IEC 85): F</div> <div>Others:</div> <div>Net weight: 2.65 kg</div> <div>Gross weight: 2.85 kg</div> <div>Shipping volume: 0.004 m³</div> <div>Country of origin: RS</div> <div>Custom tariff no.: 84137030</div>

On request UPS 15-50 N 130 50 Hz

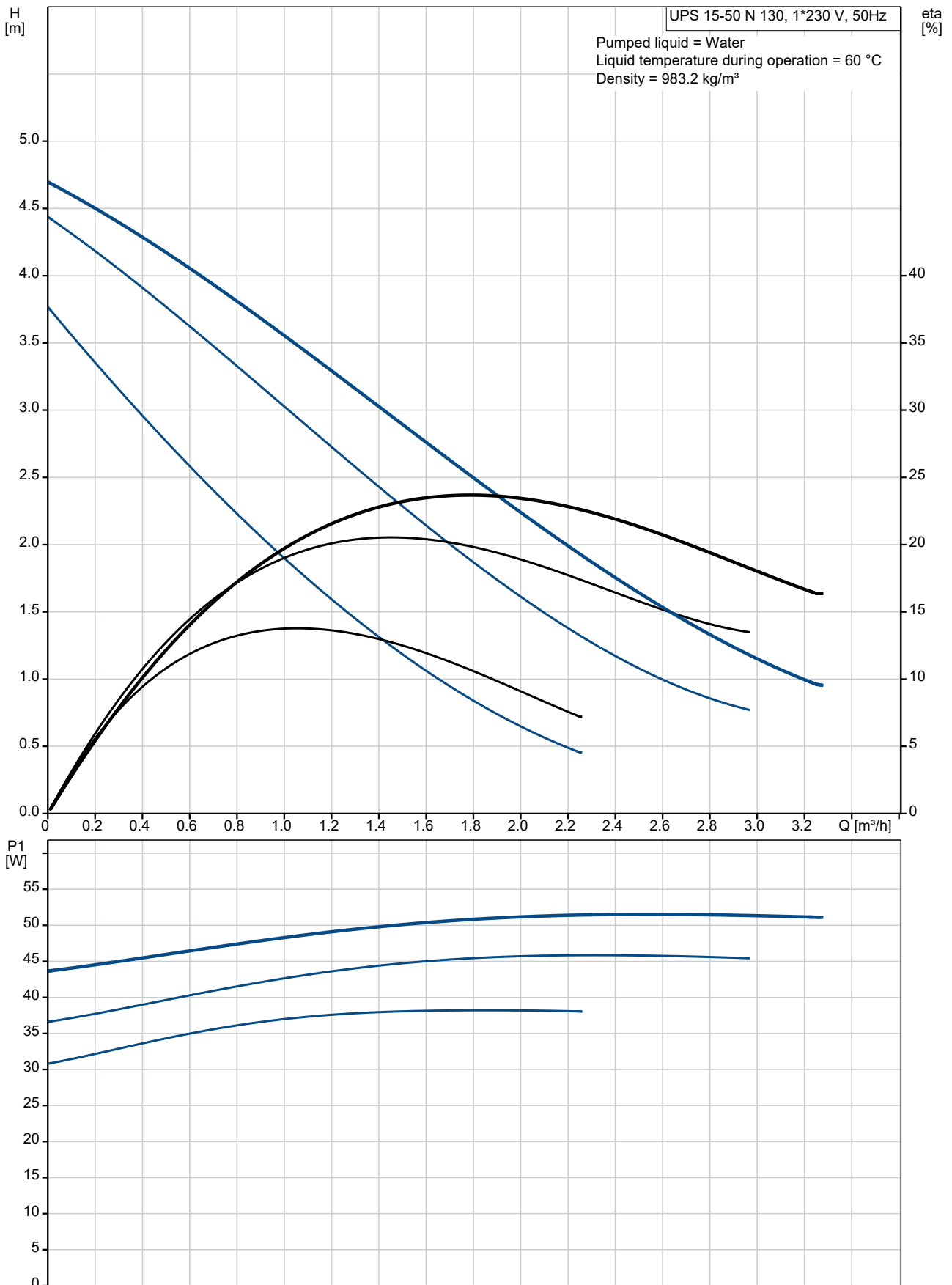

Description	Value
General information:	
Product name:	UPS 15-50 N 130
Product No:	On request
EAN number:	On request
Technical:	
Speed no:	3
Head max:	50 dm
TF class:	110
Approvals on nameplate:	CE, WEEE, UKCA
Materials:	
Pump housing:	Stainless steel
Pump housing:	DIN W.-Nr. 1.4301
Impeller:	Composite, PES/PP
Installation:	
Amb. max at 80 dgr C liquid:	40 °C
Maximum operating pressure:	10 bar
Pipe connection:	G 1 1/2
Pressure rating:	PN 10
Port-to-port length:	130 mm
Fittings:	Y
Liquid:	
Pumped liquid:	Water
Liquid temperature range:	2 .. 110 °C
Selected liquid temperature:	60 °C
Density:	983.2 kg/m³
Electrical data:	
Power input in speed 1:	35 W
Power input in speed 2:	45 W
Max. power input:	50 W
Mains frequency:	50 Hz
Rated voltage:	1 x 230 V
Current in speed 1:	0.16 A
Current in speed 2:	0.2 A
Current in speed 3:	0.23 A
Capacitor size - run:	2 µF
Enclosure class (IEC 34-5):	IP44
Insulation class (IEC 85):	F
Built-in motor protection:	NONE
Thermal protec:	Impedance protected
Controls:	
Pos term box:	9H
Others:	
Net weight:	2.65 kg
Gross weight:	2.85 kg
Shipping volume:	0.004 m³
Country code:	GB
Country of origin:	RS
Custom tariff no.:	84137030

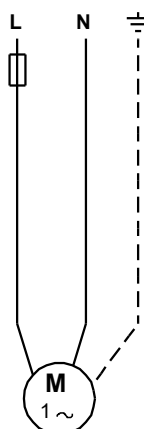
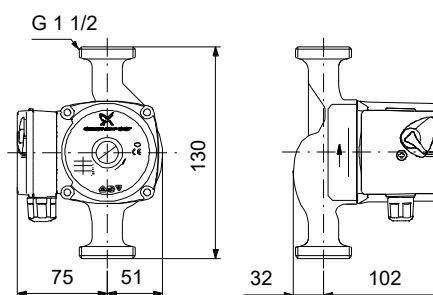
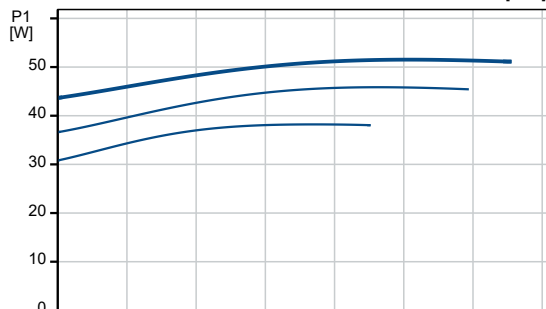
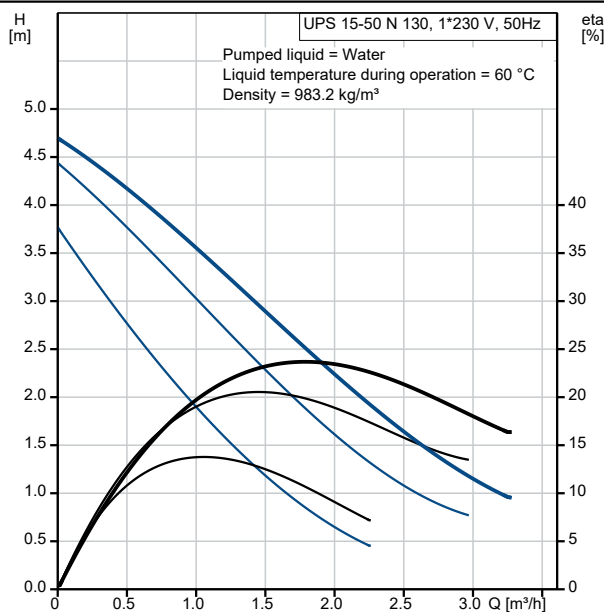

Technical drawing of the Grundfos 15-100 pump, showing front and side views with dimensions.

Front View (Top):

- Overall width: 130
- Overall height: 102
- Flange diameter: 51
- Motor housing width: 75

Side View (Bottom):

- Overall width: 130
- Overall height: 102
- Flange diameter: 51
- Motor housing width: 75

The drawing includes a central vertical dashed line indicating symmetry. The front view shows the pump head with a central discharge port and a pressure rating of 10 bar. The side view shows the motor housing with a terminal box and a mounting bracket.

Printed from Grundfos Product Centre [2022.33.001]

On request UPS 15-50 N 130 50 Hz

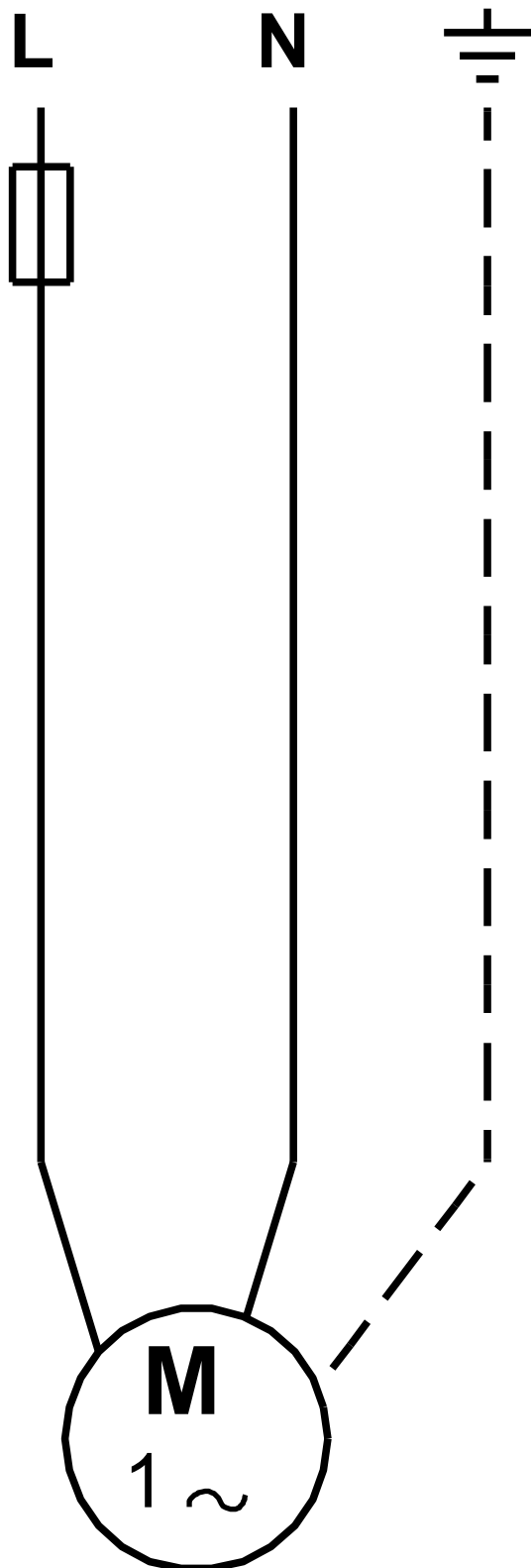

Note! All units are in [mm] unless others are stated.

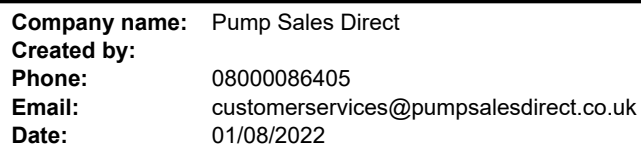

Position	Your pos.	Product name	Amount	Product No	Total
		UPS 15-50 N 130	1	On request	Price on request