

Qty.	Description
1	<p>CM 5-5 S-R-I-E-AQQE C-A-A-N</p>  <p>Product No.: On request</p> <p>Compact, reliable, horizontal, multistage, end-suction centrifugal pump with axial suction port and radial discharge port. The pump is self-priming and can create a suction lift of up to 4 m metres. Pump materials in contact with the liquid are in stainless steel. The mechanical shaft seal is a special designed, unbalanced O-ring seal. Pipework connection is via internal Whitworth pipe threads, Rp (ISO 7/1).</p> <p>The pump is fitted with a 1-phase, foot-mounted, fan-cooled asynchronous motor.</p> <p>Controls:</p> <p>Frequency converter: NONE</p> <p>Liquid:</p> <p>Pumped liquid: Water</p> <p>Liquid temperature range: 0 .. 60 °C</p> <p>Selected liquid temperature: 20 °C</p> <p>Density: 998.2 kg/m³</p> <p>Technical:</p> <p>Pump speed on which pump data are based: 2900 rpm</p> <p>Rated flow: 4.7 m³/h</p> <p>Rated head: 37.96 m</p> <p>Code for shaft seal: AQQE</p> <p>Approvals: CE,EAC</p> <p>Approvals for drinking water: WRAS,ACS,UBA</p> <p>Curve tolerance: ISO9906:2012 3B</p> <p>Self priming: 4 m</p> <p>Materials:</p> <p>Pump housing: Stainless steel EN 1.4301 AISI 304</p> <p>Impeller: Stainless steel EN 1.4301 AISI 304</p> <p>Installation:</p> <p>Range of ambient temperature: -20 .. 55 °C</p> <p>Maximum operating pressure: 16 bar</p> <p>Max pressure at stated temp: 16 bar / 60 °C 16 bar / 60 °C</p> <p>Type of connection: Rp</p> <p>Size of inlet connection: 1 inch</p> <p>Size of outlet connection: 1 inch</p> <p>Outlet position: 12</p> <p>Electrical data:</p> <p>Motor standard: IEC</p> <p>Frame size: 80B</p> <p>Rated power - P2: 0.9 kW</p> <p>Mains frequency: 50 Hz</p> <p>Suitable for 50/60 Hz: N</p> <p>Rated voltage: 1 x 220-240 V V</p> <p>Service factor: 1.00</p> <p>Rated current: 5.4-5.0 A</p>

Qty.	Description
1	<div> <div>Starting current:430-430 %</div> <div>Rated speed:2750-2790 rpm</div> <div>Enclosure class (IEC 34-5):IP55</div> <div>Insulation class (IEC 85):F</div> <div>Built-in motor protection:PTO</div> <div>Others:</div> <div>Terminal box position:12</div> <div>Minimum efficiency index, MEI ≥:0.7</div> <div>Net weight:17 kg</div> <div>Gross weight:19.5 kg</div> <div>Country of origin:HU</div> <div>Custom tariff no.:84137075</div> </div>

On request CM 5-5 S-R-I-E-AQQE C-A-A-N 50 Hz

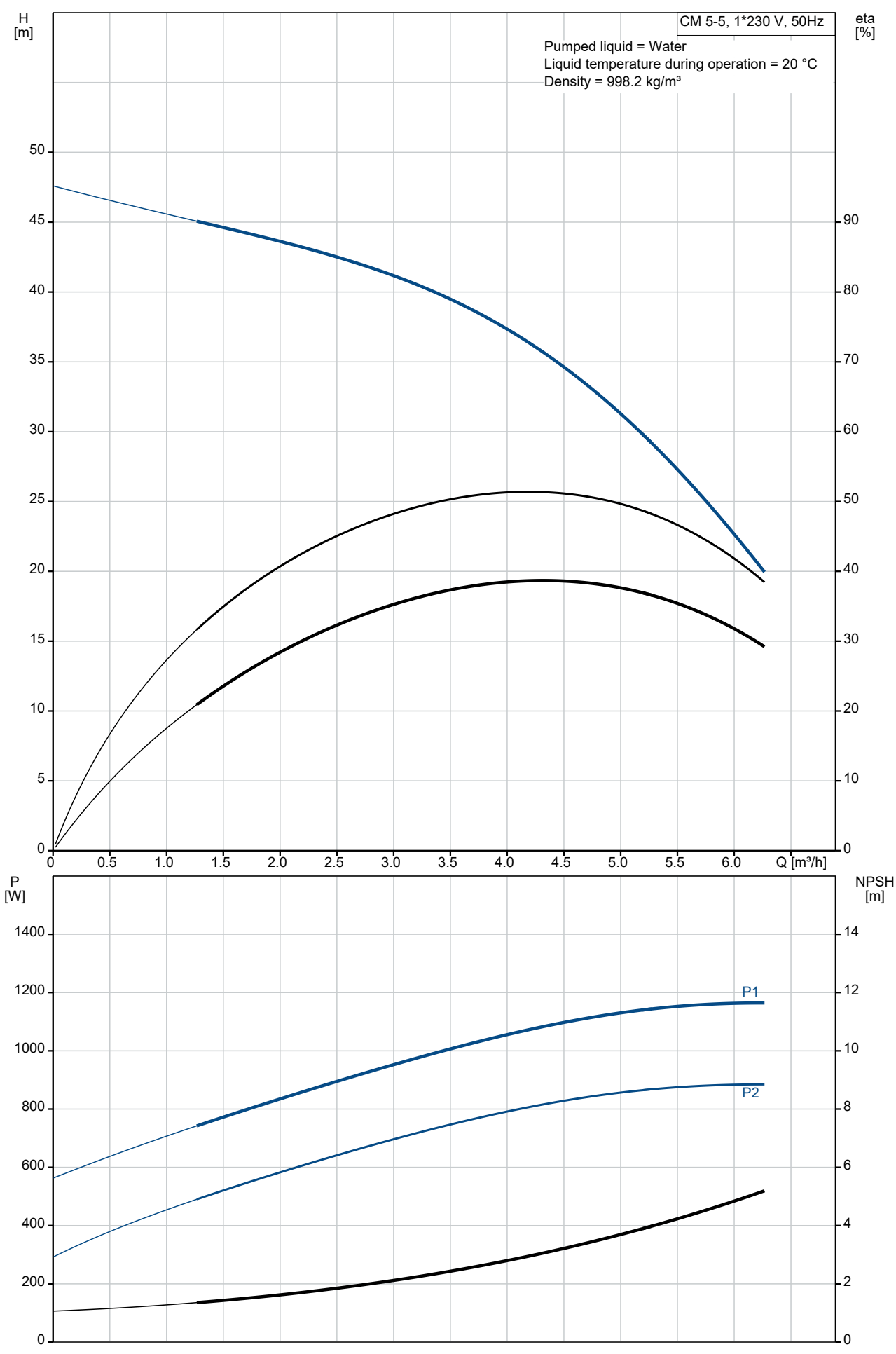

Description	Value
General information:	
Product name:	CM 5-5 S-R-I-E-AQQE C-A-A-N
Product No:	On request
EAN number:	On request
Technical:	
Pump speed on which pump data are based:	2900 rpm
Rated flow:	4.7 m³/h
Rated head:	37.96 m
Impellers:	5
Code for shaft seal:	AQQE
Approvals:	CE, EAC
Approvals for drinking water:	WRAS, ACS, UBA
Curve tolerance:	ISO9906:2012 3B
Pump version:	S
Model:	A
Self priming:	4 m
Materials:	
Pump housing:	Stainless steel
Pump housing:	EN 1.4301
Pump housing:	AISI 304
Impeller:	Stainless steel
Impeller:	EN 1.4301
Impeller:	AISI 304
Material code:	I
Code for rubber:	E
Installation:	
Range of ambient temperature:	-20 .. 55 °C
Maximum operating pressure:	16 bar
Max pressure at stated temp:	16 bar / 60 °C
Max pressure at stated temp:	16 bar / 60 °C
Type of connection:	Rp
Size of inlet connection:	1 inch
Size of outlet connection:	1 inch
Outlet position:	12
Connect code:	R
Liquid:	
Pumped liquid:	Water
Liquid temperature range:	0 .. 60 °C
Selected liquid temperature:	20 °C
Density:	998.2 kg/m³
Electrical data:	
Motor standard:	IEC
Frame size:	80B
Rated power - P2:	0.9 kW
Mains frequency:	50 Hz
Suitable for 50/60 Hz:	N
Rated voltage:	1 x 220-240 V V
Service factor:	1.00
Rated current:	5.4-5.0 A
Starting current:	430-430 %
Rated speed:	2750-2790 rpm
Enclosure class (IEC 34-5):	IP55
Insulation class (IEC 85):	F
Built-in motor protection:	PTO
Controls:	
Frequency converter:	NONE
Others:	
Terminal box position:	12
Minimum efficiency index, MEI ≥:	0.7
Net weight:	17 kg
Gross weight:	19.5 kg
Country of origin:	HU

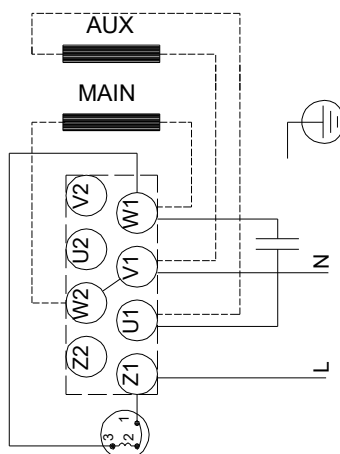
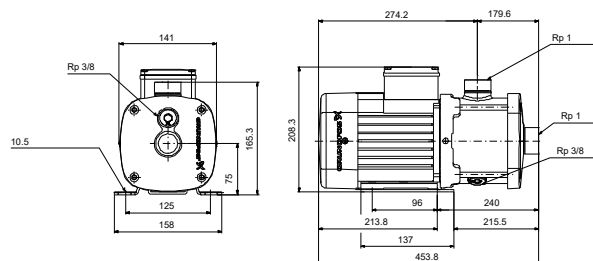
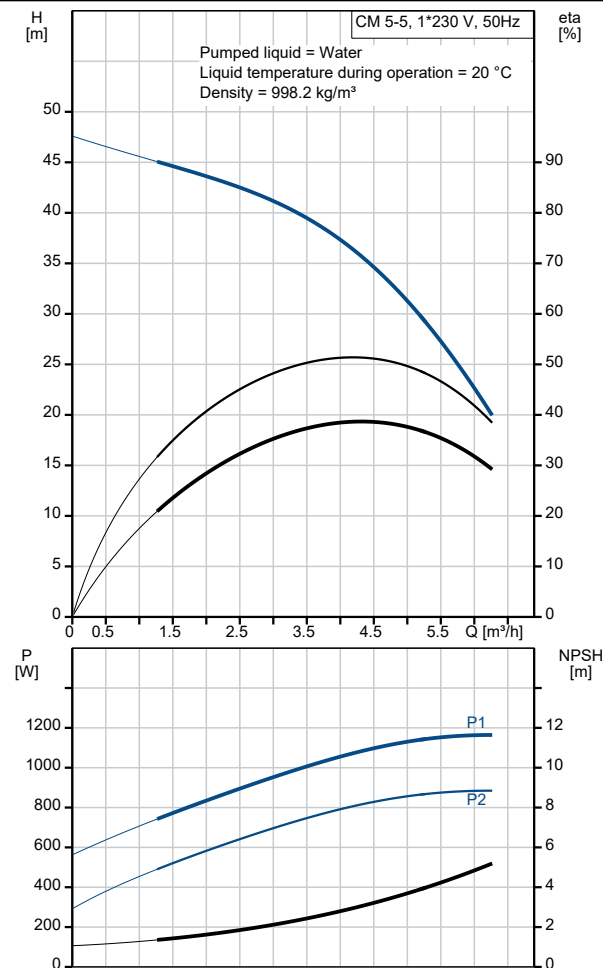

Description	Value
Custom tariff no.:	84137075

On request CM 5-5 S-R-I-E-AQQE C-A-A-N 50 Hz

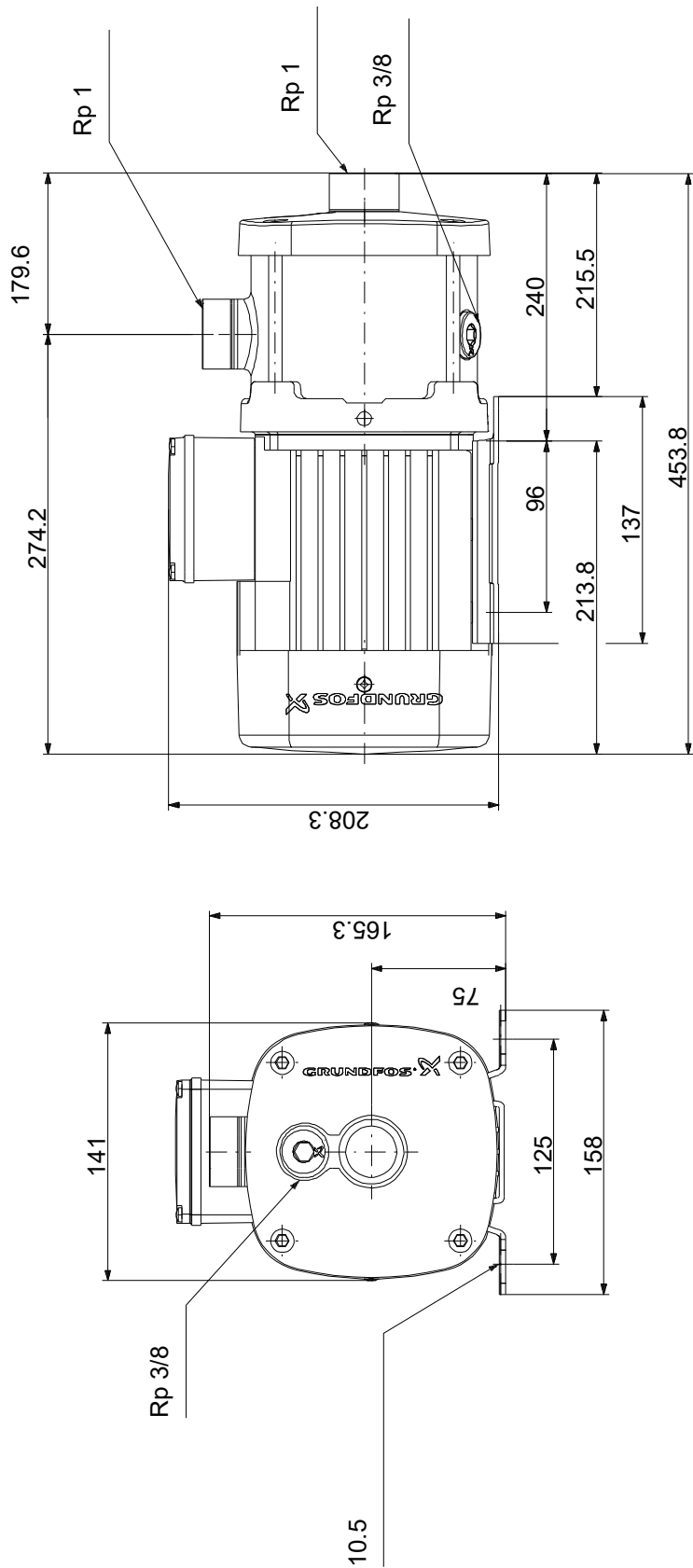

Note! All units are in [mm] unless others are stated.
Disclaimer: This simplified dimensional drawing does not show all details.

On request CM 5-5 S-R-I-E-AQQE C-A-A-N 50 Hz

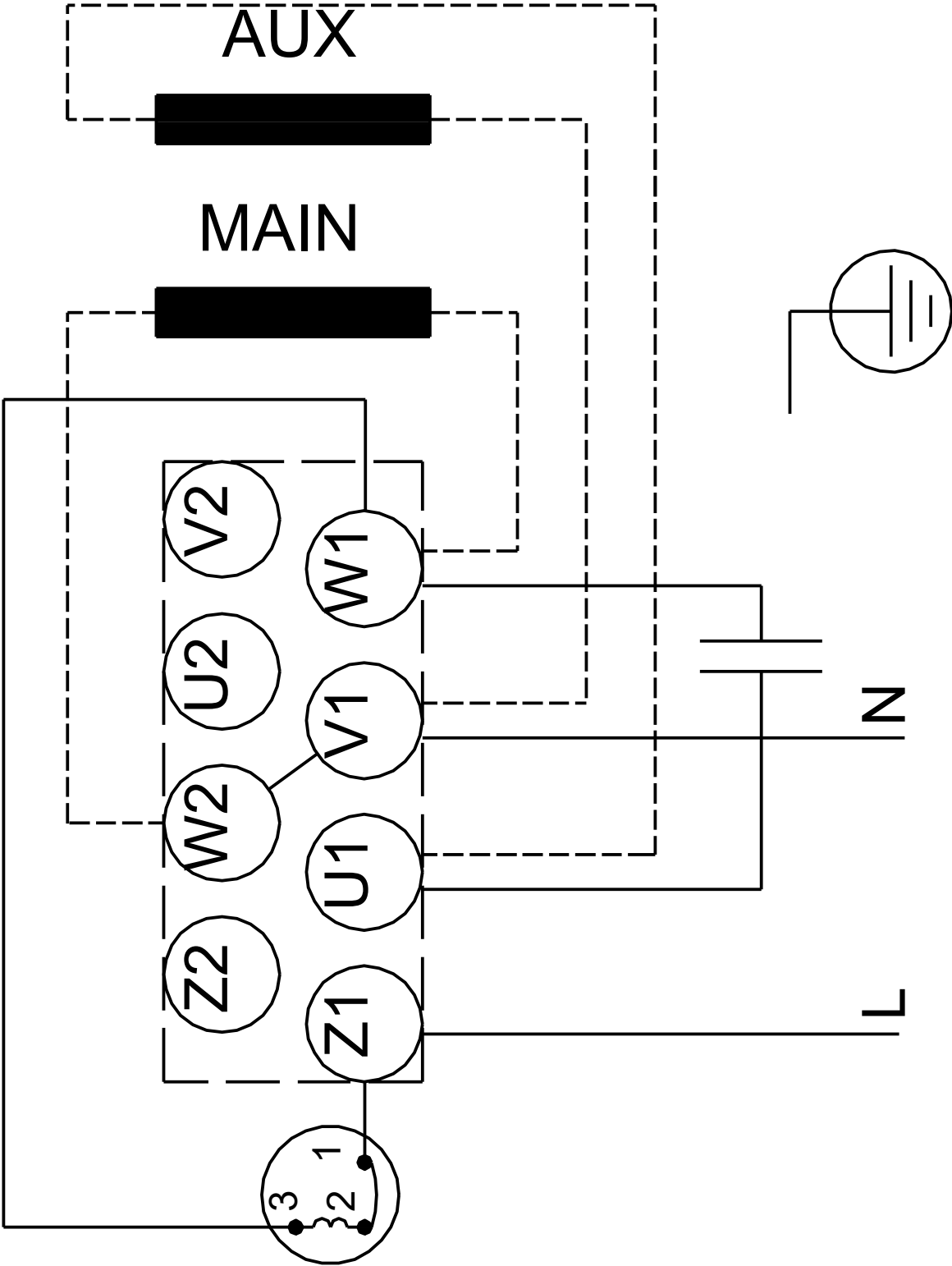

Note! All units are in [mm] unless others are stated.

Order Data:	
--------------------	--

Position	Your pos.	Product name	Amount	Product No	Total
		CM 5-5	1	On request	Price on request