

Submersible Pumps

With integral automatic float switch

The Supersub 150VA and 250VA Submersible pumps offer a compact design ideal for general purpose applications where space is at a premium. A simple lever allows quick selection of manual or automatic mode of operation. Both models are supplied complete with a stepped hose union and elbow.

Application

The Supersub 150VA and 250VA are both ideal for transfer of rain, dirty or waste water, where automatic control is required in a confined space, cellar drainage is a popular application.

Features

- Automatic-vertical float switch.
- Switch for automatic/manual mode.
- Suction to a remaining depth of 3-6 mm (manual mode).
- Suction to a remaining depth of 35 mm (auto mode).
- Passes suspended solids up to 5 mm diameter.
- Motor can be partially submerged for short term operation.
- Top vertical outlet connection.

Materials

Body	Polypropylene
Impeller	Polyamide
Motor casing	Aluminium & Stainless steel
Pump shaft	304 Stainless/ceramic
Seal	Two separate lip seals

Operating Conditions

Max. liquid temp.	35°C
Min. liquid temp.	4°C
Max. immersion depth	7 m

Cable

H05RN-F3	10 m
----------	------

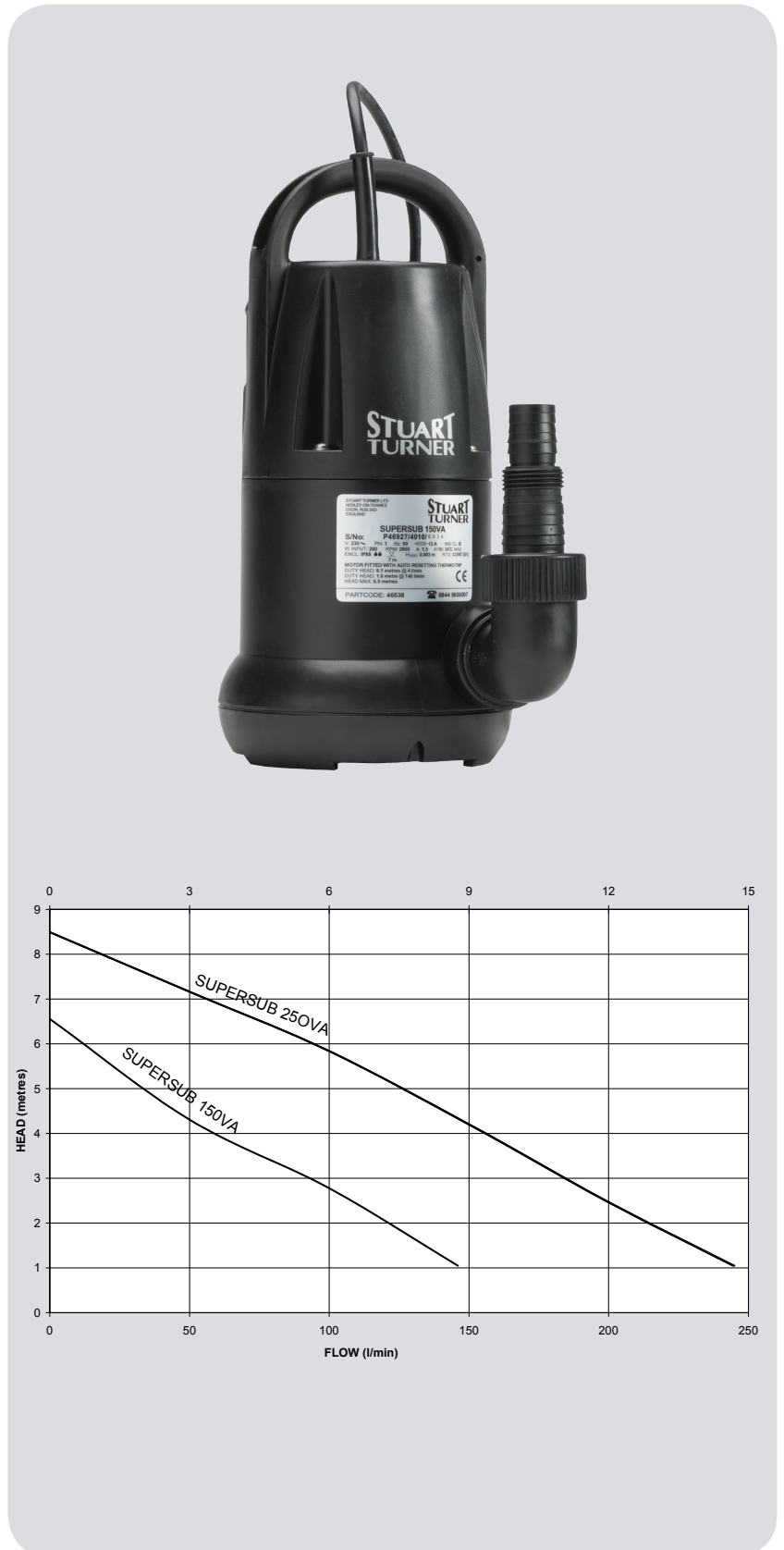

Submersible Pumps

With integral automatic float switch

Model	Motor*	Nominal Watts	Watts full flow	Amps full load	Impeller	Seal	Carton dims. mm			Gross weight (packed) kg	Part no.
							L	x W	xH		
150VA	230/1/50	180	275	1.2	Polyamide	Double Lip	220	160	360	4.6	46538
250VA	230/1/50	350	508	2.2	Polyamide	Double Lip	220	160	360	4.8	46539

*Built to IPx8, all motors are designed for continuous running and feature thermal overload protection. A residual current device having a rated current not exceeding 30 mA must be installed in the supply circuit.

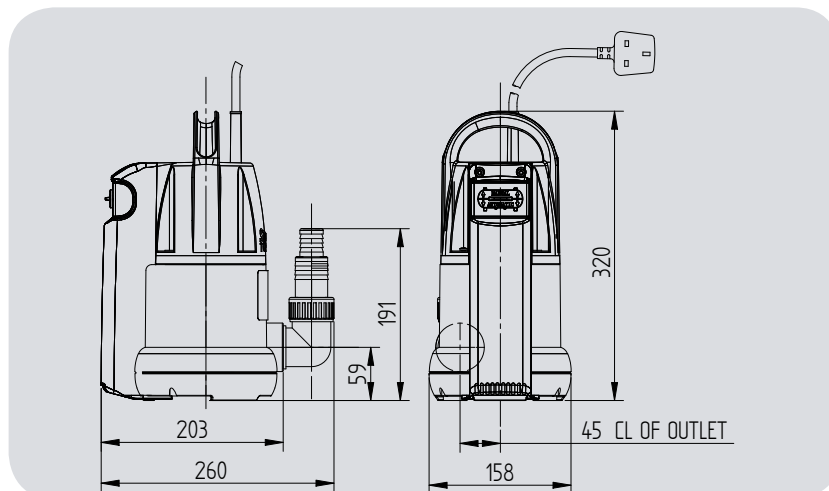
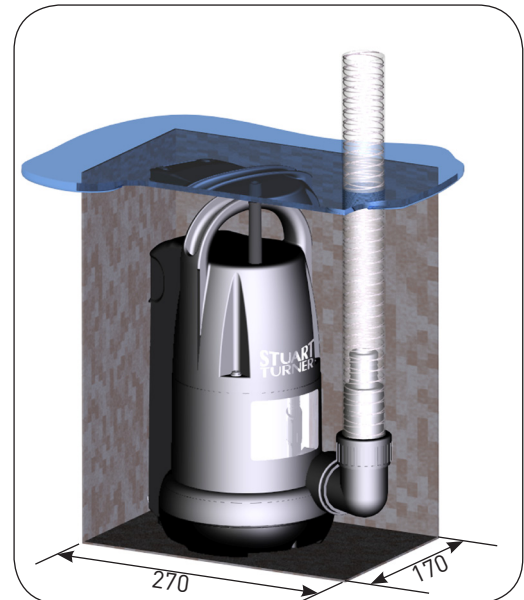
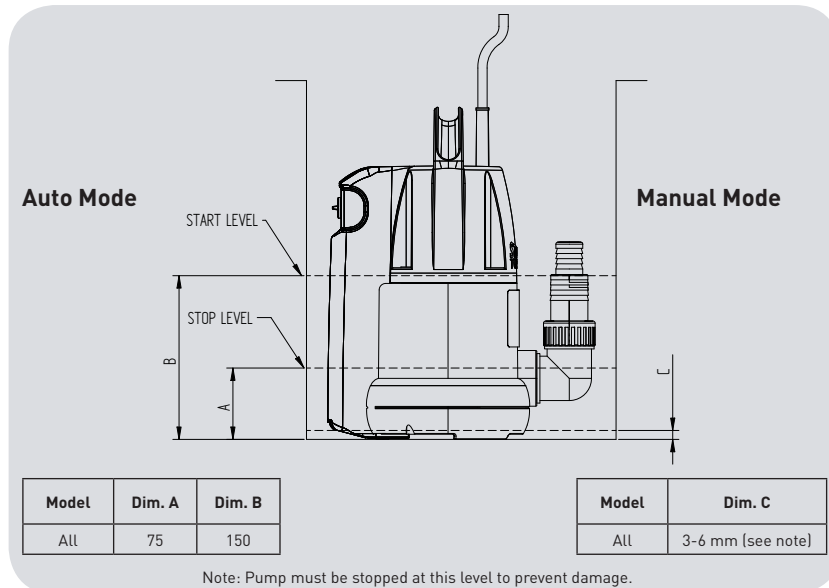

Pump Connection Sizes

All models G1½ Female.
Supplied with a G 1½ M x G 1½ M x 90° elbow and a G 1½ F stepped hose connector, suitable for 25, 32 or 38 mm bore hose.